

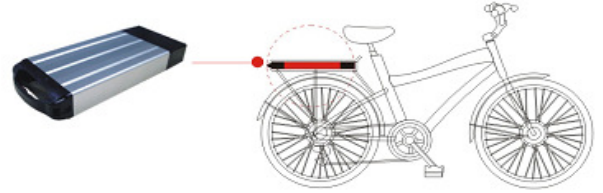

**Battery Kit 36V 9Ah Li-Ion
+ Charger for Ebike**



**CARACTERISTIQUES ELECTRIQUES
ELECTRICAL CHARACTERISTICS**

Cell Brand	Panasonic
Cell Code	IFP287194S10A
Chemistry	CGR18650CG
Voltage	36 V
Capacity	9 Ah
Rate	324 Wh
Configuration	10S4P
Inner Resistance	≤75 mΩ
Limit	42.5V
Continuous Discharge Current	13 A
Burst Discharge Current	30 A
Operate Temp. Charge	0~45 °C
Operate Temp. Discharge	-20~60 °C
Storage Temp.	-20~40 °C
Cycle Life	500 Times
PCB SAFETY protection	Over-discharge
	Over-current protection
	Over-charge
	Secondary protection

**CARACTERISTIQUES PHYSIQUES
PHYSICAL CHARACTERISTICS**

Accumulateur / Battery	
Dimension (mm)	340 x 151 x 53 (+/- 1)
Poids / Weight (g.)	3040

Accessories include :



Size: 115.15 x 58.90 x 31.30 mm
 Input Voltage: 100-240 V
 Output Voltage: 42.3 V
 Output Current: 1.35 A
 Cord Length: 1000 mm

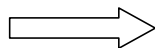

Size: 66.00 x 52.00 x 149.00 mm
 Length: 1500 mm

Features :

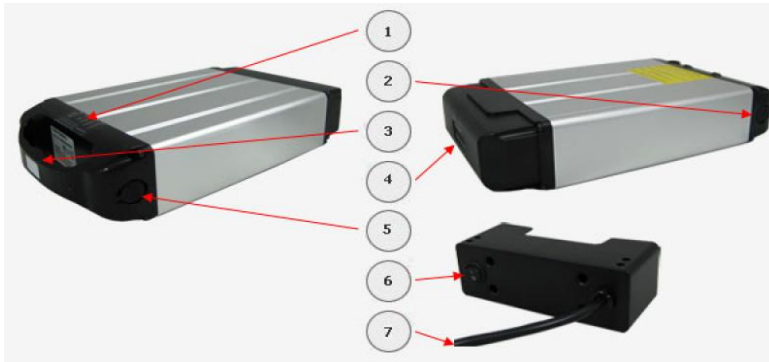

1	4-Level LED indicator	4 Led indicateur de charge
2	15A Fuse	Fusible 15A
3	Handlebar	Poignet
4	Battery contact socket	Prise batterie
5	Charging input jack	Prise jack pour recharger la batterie
6	Power on/off	Bouton marche/arret
7	Connecting cable	Cable de connexion



The Four-level LED indicates current power status



Not much space is needed to install the portable battery into the rear carrier.



The 15A fuse, serves as a second protection device, can prevent the battery pack from excessive discharge.



Battery can be recharged either by fastening on the bike or by itself with the provided AC adapter.



The power on/off button is set on the battery base.