

Réglette Border - 99962



Réglette LED Border Clever Connect Paulmann - 7,5W - 500mm - Tunable White

Réf 99963 **51.08€^{TTC*}**

<https://www.domomat.com/103795-reglette-led-border-clever-connect-paulmann-75w-500mm-tunable-white-paulmann-99963.html>



Réglette LED Border Clever Connect Paulmann - 5W - 300mm - Tunable White

Réf 99962 **44.60€^{TTC*}**

<https://www.domomat.com/105220-reglette-led-border-clever-connect-paulmann-5w-300mm-tunable-white--paulmann-99962.html>

*Retrouvez tous les produits de la catégorie
Éclairage de meubles de cuisine Paulmann
chez Domomat !*

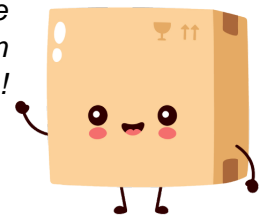

* : Prix sur le site Domomat.com au 28/04/2024. Le prix est susceptible d'être modifié.



Paulmann

Safety Instructions

1, 2, 3, 4, 5, 6, 7, 8, 11, 14, 19, 22, 23, 24, 25, 26, 27, 28, 29, 33, 34;



www.paulmann.com/symbols

Paulmann Licht GmbH
Quezinger Feld 2
31832 Springe
Germany

www.paulmann.com

Art.-Nr.: 999.62
999.63
(+MA 326)PEO 10/20



99962/63

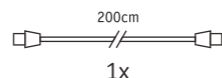
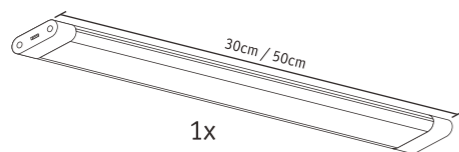

1x



2x

2x

2x



A

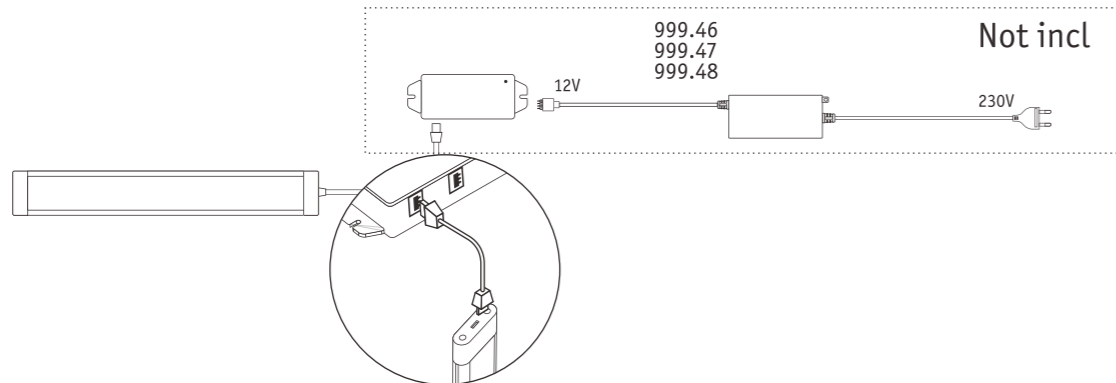

B1

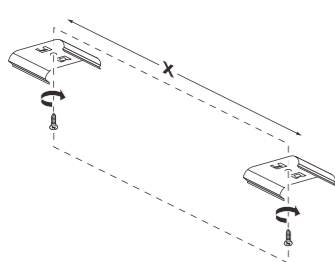

B2

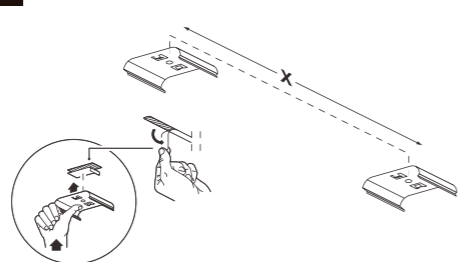

C

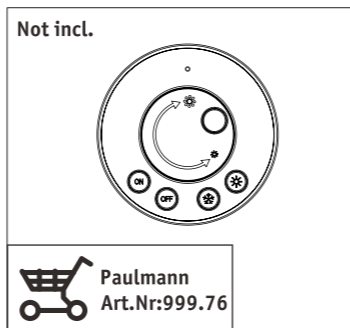
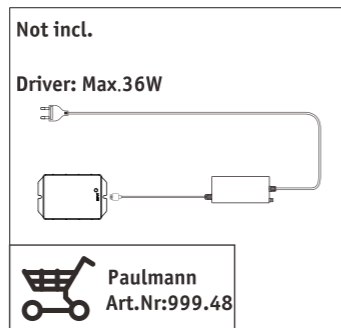
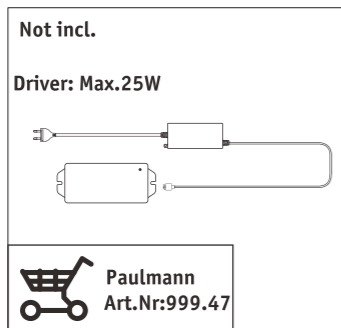
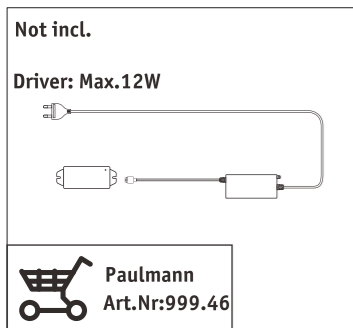
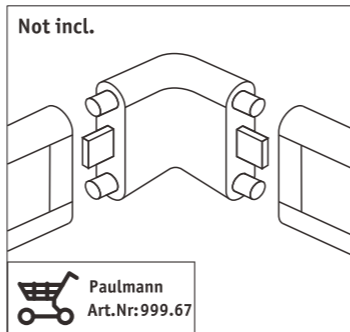
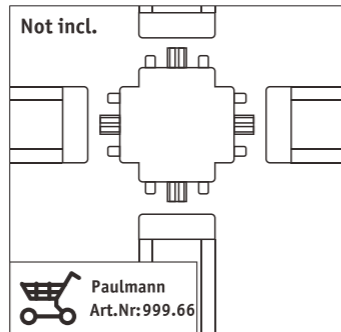
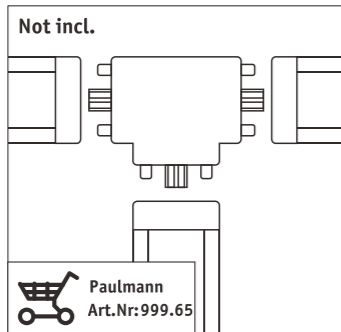
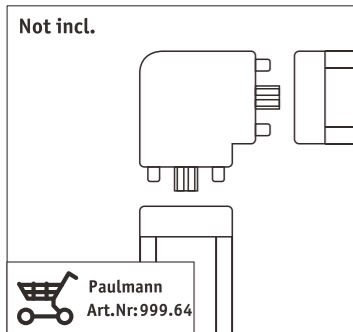
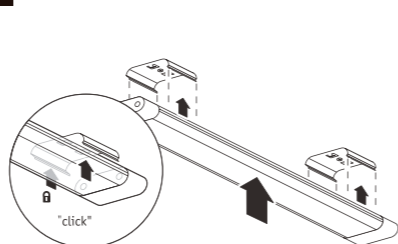

Function of keys

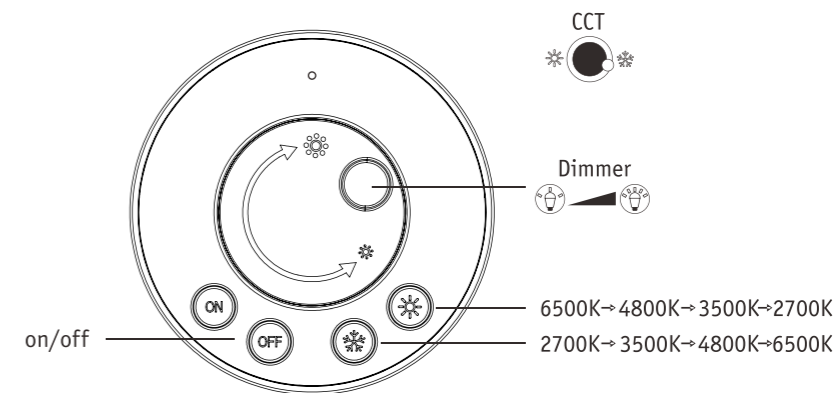

Code Matching

(Press the "ON" button one time within 5s of connecting to the controller)

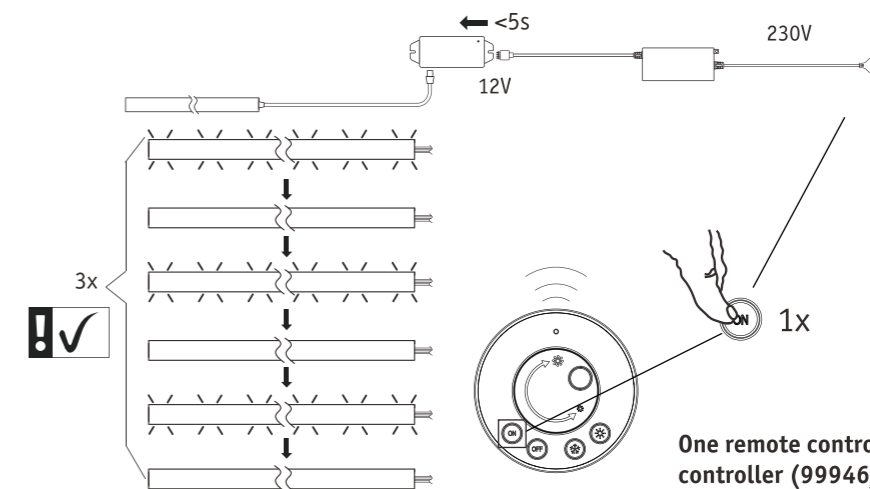

One remote control can control countless controller (99946/99947/99948), but a controller (99946/99947/99948) can be only controlled by 4 pcs remote control.

Code Clearing

(Press the "NO" button three times within 5s of cancelling the connection to the controller)

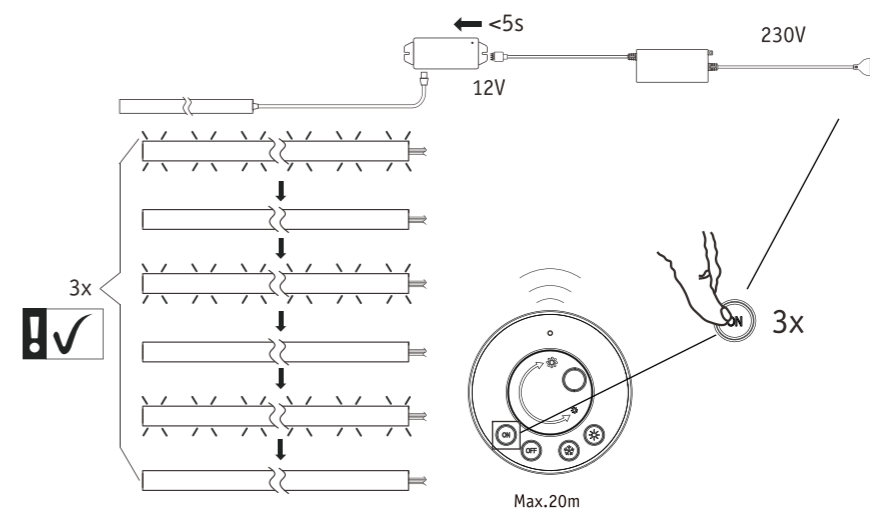

Hiermit erklärt Paulmann Licht, dass der Funkanlagentyp Art.-Nr.: 999.62/999.63 der Richtlinie 2014/53/EU entspricht. Der vollständige

Text der EU-Konformitätserklärung ist unter der folgenden Internetadresse verfügbar: www.paulmann.de
Zugelassen für den Betrieb in allen Ländern der EU / Approved for operating in all European countries

CE: Konform mit / in accordance with / conformement a 2014/30/EU, 2014/53/EU <http://www.paulmann.com/ce>

Funk-Frequenz :2.4GHz -2.4835GHz Abgestrahlte Energie :10mW

Doesn't apply for the geographical area within a radius of 20km from the centre on "Ny Alesund"

